

**DUST CONTROL:**

• NOTE: DURING EXCAVATION, DEMOLITION AND CONSTRUCTION, ADEQUATE MEASURES SHALL BE TAKEN TO PREVENT DUST FROM AFFECTING THE AMENITY OF THE NEIGHBORHOOD.

THE FOLLOWING MEASURES MUST BE ADOPTED:

1. PHYSICAL BARRIERS SHALL BE ERECTED AT RIGHT ANGLES TO PREVENT WIND DIRECTION OR SHALL BE PLACED AROUND OR OVER DUST SOURCES TO PREVENT WIND OR ACTIVITY FROM GENERATING DUST.
2. EARTHWORKS AND SCHEDULING ACTIVITIES SHALL BE MANAGED TO COINCIDE WITH THE NEXT STAGE OF DEVELOPMENT TO MINIMISE THE AMOUNT OF TIME THE SITE IS LEFT TO CUT OR EXPOSED.
3. ALL MATERIALS SHALL BE STORED OR STOCKPILED AT THE BEST LOCATIONS.
4. THE GROUND SURFACE SHOULD BE DAMPENED SLIGHTLY TO PREVENT DUST FROM BECOMING AIRBORNE BUT SHOULD NOT BE WET TO THE EXTENT THAT RUN-OFF OCCURS.
5. ALL VEHICLES CARRYING SOIL OR RUBBLE TO OR FROM THE SITE SHALL AT ALL TIMES BE COVERED TO PREVENT THE ESCAPE OF DUST.
6. ALL EQUIPMENT WHEELS SHALL BE WASHED BEFORE EXISTING THE SITE USING MANUAL OR AUTOMATED SPRAYERS AND DRIVE - THROUGH WASHING BAYS.
7. GATES SHALL BE CLOSED BETWEEN VEHICLE MOVEMENTS SHALL BE FITTED WITH SHADE CLOTH.
8. CLEANING OF FOOTPATHS AND ROADWAYS SHALL CARRIED OUT DAILY.
9. ALL BUILDERS REFUSE, SPOIL AND/OR MATERIAL UNSUITABLE FOR USE IN LANDSCAPE AREAS SHALL BE REMOVED FROM SITE ON COMPLETION OF THE BUILDING WORKS.

**LEGEND:**

- UNDISTURBED VEGETATION
- SEDIMENT FENCE
- STOCK PILES
- STABILIZED SITE ACCESS
- MESH & GRAVEL INLET FILTER
- WATER DIVERSION
- STORMWATER PIT WITH SEDIMENT BARRIER

**NOTES:**

1. ALL EROSION AND SEDIMENT CONTROL MEASURES TO BE INSPECTED AND MAINTAINED DAILY BY SITE MANAGER IN ACCORDANCE WITH COUNCIL REQUIREMENTS.
2. ALL STOCKPILES TO BE CLEAR FROM DRAINS, GUTTERS AND FOOTPATHS.
3. DRAINAGE IS TO BE CONNECTED TO STORMWATER SYSTEM AS SOON AS POSSIBLE.
4. ROADS AND FOOTPATH TO BE SWEEPED DAILY AS REQUIRED BY COUNCIL.
5. IF YOU DO NOT COMPLY WITH COUNCIL REQUIREMENTS & DOCUMENTATION, YOU MAY BE LIABLE TO PROSECUTION FROM GOVERNMENT AUTHORITIES.

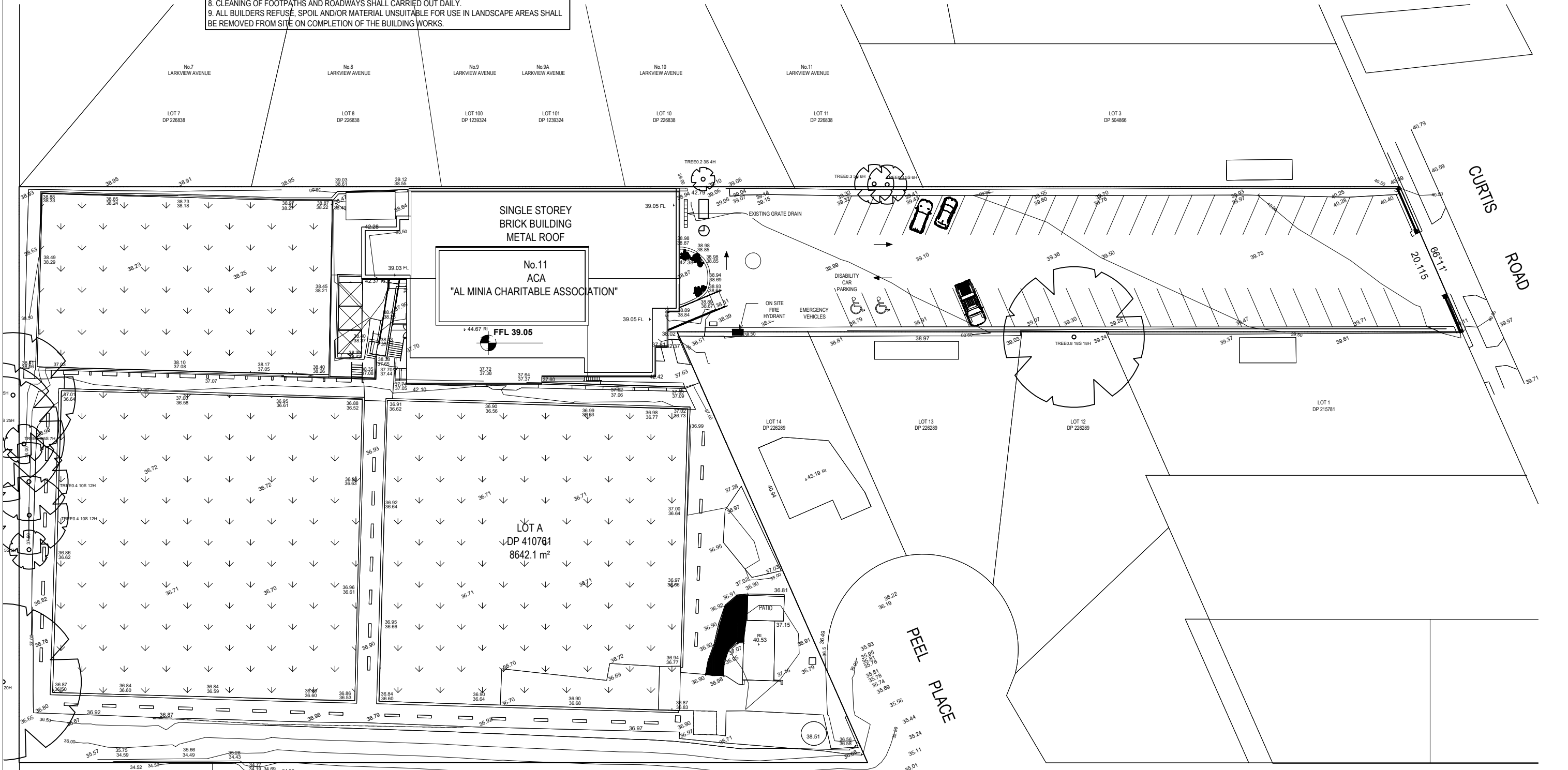
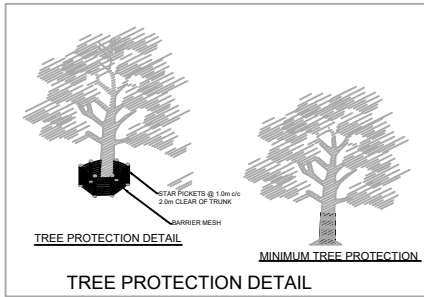

REV. NO.	DESCRIPTION TO REVISION	REV. BY	DATE
A	ISSUE FOR DA	A.E	07/05/2025

**GENERAL NOTES**

Figured dimensions & larger scale drawings shall be taken in preference to scaled readings.

Check all dimensions and levels on site before commencement of work or ordering materials.

All workmanship and materials shall comply with all relevant codes, ordinances, Australian standards and manufacturer's instructions.

All discrepancies shall be brought to the attention of AKT Engineering & Consulting P/L

Copyright of the material shown hereon & in the accompanying CAD files / drawing sheets vests with AKT Engineering & Consulting P/L.

AKT Engineering & Consulting P/L warrants only the original architectural data as retained by the company.

The data files are not to be altered without the written approval of AKT Engineering & Consulting P/L.

The responsibility of AKT Engineering & Consulting P/L is removed if these conditions are not observed.

ARCHITECTURAL DESIGNERS  
CIVIL & STRUCTURAL ENGINEERS  
NATHERS & BASIX ASSESSORS  
CONSTRUCTION CERTIFICATES  
ACCREDITED CERTIFIERS  
PROJECT MANAGERS

34/549-553 WOODVILLE ROAD  
GUILDFORD NSW 2161  
TEL: 02 8005 6525  
MOB: 04 268 148 88  
WWW.AKTENGINEERING.COM.AU  
INFO@AKTENGINEERING.COM.AU

**AKT**  
ENGINEERING & CONSULTING P/L

CUSTOMER	11 CURTIS ROAD CHESTER HILL, NSW LOT A D.P 410761
PROJECT	AL MINIA CHARTIABLE ASSOCIATION

TITLE: SEDIMENT CONTROL DETAILS PLAN			
PROJECT PORTION			
AL MINIA CHARTIABLE ASSOCIATION			
CHECKED PROPOSAL	APPROVED PROPOSAL	CLIENT APPROVED	ENGINEER APPROVED
DRAWN BY: A.E	SCALE: 200	A3 JOB No: 24057	DRG No: D6 REV: A